

P:\12-118\CA\LANDSCAPE\CONSTRUCTION\LANDSCAPE PLAN.DWG, WHITNEY.BRETZ, 3/21/2023, CADDON PLOT55 (BW) PLOT 22034.1 [PDF]

CONTACT INFORMATION

OWNER
COPERNICUS INVESTMENTS, LLC. &
KCID DEVELOPMENT, LLC.
811 E. MCKINLEY STREET
BOISE, IDAHO 83712

LANDSCAPE CONSULTANT
KM ENGINEERING, LLP
5725 NORTH DISCOVERY WAY
BOISE, IDAHO 83713
PHONE: (208) 639-6939
FAX: (208) 639-6930
CONTACT: ALYSSA YENSEN, PLA
EMAIL: ayensen@kmengllp.com

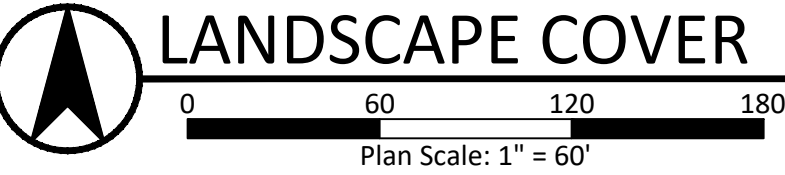

GENERAL IRRIGATION NOTES

- NO GUARANTEE IS MADE THAT ALL EXISTING UNDERGROUND UTILITIES ARE SHOWN, OR SHOWN CORRECTLY. CONTRACTOR SHALL VERIFY LOCATION OF ALL UTILITIES PRIOR TO INITIATION OF ANY DEMOLITION OR CONSTRUCTION OPERATIONS. ANY DAMAGE TO EXISTING UTILITIES SHALL BE CONTRACTOR'S RESPONSIBILITY.
- THE CONTRACTOR IS RESPONSIBLE TO FURNISH AND INSTALL A COMPLETE IRRIGATION SYSTEM WHICH PROVIDES ADEQUATE WATER COVERAGE TO ALL LAWN AND PLANTING AREAS. THE WORK SHALL CONSIST OF PROVIDING AND INSTALLING ALL MATERIALS NECESSARY FOR A COMPLETE SYSTEM INCLUDING POINT OF CONNECTION, PIPE, VALVES, FITTINGS, HEADS, AUTOMATIC CONTROLS, AND ALL ASSOCIATED LABOR. THE CONTRACTOR SHALL FURNISH THE ARCHITECT WITH A SHOP DRAWING SHOWING THE DESIGN LAYOUT, PIPE SIZE AND TYPE, VALVE LOCATIONS AND TYPE, HEAD LOCATIONS AND TYPE, CONTROLLER LOCATION AND TYPE, WIRE SIZING, ETC... FOR APPROVAL PRIOR TO CONSTRUCTION.
- CONTRACTOR SHALL OBTAIN AND PAY FOR ALL PERMITS AND FEES REQUIRED FOR THIS WORK
- ALL MATERIALS SHALL BE NEW AND WITHOUT FLAWS OR DEFECTS.
- INSTALLATION SHALL COMPLY WITH ALL NATIONAL, STATE, AND LOCAL LAWS AND ORDINANCES.
- POINT OF CONNECTION: COMPLY WITH REQUIREMENTS OF UTILITY SUPPLYING WATER FOR PREVENTION OF BACKFLOW AND BACK-SIPHONAGE
- COVERAGE: THE IRRIGATION SYSTEM SHALL BE DESIGNED TO PROVIDE ONE HUNDRED PERCENT (100%) COVERAGE WITH HEAD TO HEAD SPACING OR TRIANGULAR SPACING AS APPROPRIATE.
- MATCHED PRECIPITATION RATES: SPRINKLER HEADS SHALL HAVE MATCHED PRECIPITATION RATES WITHIN EACH CONTROL VALVE.
- IRRIGATION DISTRICTS: SPRINKLER HEADS IRRIGATING LAWN OR OTHER HIGH WATER DEMAND AREAS SHALL BE CIRCUITED SO THAT THEY ARE ON SEPARATE ZONES FROM THOSE IRRIGATING TREES, SHRUBS, OR OTHER REDUCED WATER DEMAND AREAS.
- OVERSPRAY: SPRINKLER HEADS SHALL BE ADJUSTED TO REDUCE OVERSPRAY ONTO IMPERVIOUS SURFACES SUCH AS STREETS, SIDEWALKS, DRIVEWAYS, AND PARKING AREAS.
- PRIOR TO COMMENCING WORK, CONTRACTOR TO CONFIRM PSI IS ADEQUATE TO FURNISH AND INSTALL A COMPLETE IRRIGATION SYSTEM WHICH PROVIDES ADEQUATE WATER COVERAGE TO ALL LAWN AND PLANTING AREAS. SHOULD THE PSI BE LESS THAN ADEQUATE, NOTIFY THE ARCHITECT IMMEDIATELY. IN THE EVENT THAT THE ARCHITECT IS NOT NOTIFIED PRIOR TO THE START OF CONSTRUCTION, THE CONTRACTOR SHALL ASSUME FULL RESPONSIBILITY FOR ANY NECESSARY REVISIONS.
- WHERE APPLICABLE, LABEL ALL IRRIGATION RISERS, FAUCETS, VALVE BOXES, AND VAULTS WITH DURABLE TAGS CARRYING THE WARNING "DANGER-UNSAFE WATER OR NON-POTABLE WATER."
- INSTALL ALL PIPING AND VALVES IN PLANTING AREAS WHERE POSSIBLE, AND LOCATE ELECTRIC CONTROL AND QUICK COUPLING VALVES IN GROUND COVER/SHRUB AREAS, 6" TO 12" AWAY FROM EDGE OF PAVEMENT FOR EASE OF ACCESS.
- PROVIDE UNDERGROUND IRRIGATION SYSTEM AS A COMPLETE UNIT PRODUCED BY A SINGLE ACCEPTABLE MANUFACTURER, INCLUDING HEADS, VALVES, CONTROLS, AND ACCESSORIES.
- A MIN. OF 4" POP-UPS ARE TO BE USED IN ALL LAWN AREAS. DRIP IRRIGATION TO BE USED IN ALL PLANTER BEDS.
- THE IRRIGATION CONTRACTOR IS RESPONSIBLE TO SIZE CIRCUIT PIPING, WATER VELOCITY IN ALL PIPES SHALL NOT EXCEED FIVE FEET PER SECOND. MINIMUM PIPE SIZE TO BE 1".
- CONTRACTOR IS RESPONSIBLE FOR INSTALLING SLEEVES UNDER ALL ROADWAY, PARKING, AND WALKWAY SURFACES. EXTEND 6" MINIMUM BEYOND SURFACE EDGE. IDENTIFY ENDPPOINTS OF SLEEVING.
- ALL IRRIGATION HEADS LOCATED ADJACENT TO ROAD SURFACES NOT PROTECTED BY A VERTICAL CONCRETE CURB SHALL BE PLACED 18" FROM THE EDGE OF THE ROAD SURFACE.
- WHERE APPLICABLE, CONTRACTOR IS RESPONSIBLE TO PROVIDE 120 VOLT POWER AND ALL REQUIRED CIRCUITS FROM THE ELECTRICAL PANEL TO THE IRRIGATION CONTROLLER. SIZE WIRE AND CONDUIT AS REQUIRED.
- WHERE APPLICABLE, CONTRACTOR IS RESPONSIBLE TO PROVIDE 120 VOLT POWER AND ALL REQUIRED CIRCUITS FROM THE ELECTRICAL PANEL TO THE IRRIGATION CONTROLLER. SIZE WIRE AND CONDUIT AS REQUIRED.
- CONTRACTOR SHALL ENSURE THAT THE EXISTING IRRIGATION SYSTEM REMAINS OPERABLE DURING CONSTRUCTION AND THAT FOLLOWING CONSTRUCTION, THE EXISTING IRRIGATION SYSTEM OPERATES AS GOOD, OR BETTER THAN EXISTED PRIOR TO THIS PROJECT.
- CONTRACTOR IS RESPONSIBLE TO REPAIR ALL EXISTING IRRIGATION COMPONENTS DAMAGED AS A RESULT OF NEW CONSTRUCTION, INCLUDING ADJACENT PROPERTIES. REPAIR INCLUDES BUT IS NOT LIMITED TO PIPING, VALVES, HEADS, DRIP COMPONENTS, CONTROL WIRES AND EQUIPMENT, AND SLEEVES. IF APPLICABLE, IRRIGATION CONTRACTOR SHALL ENSURE THAT THE EXISTING IRRIGATION SYSTEM REMAINS OPERABLE DURING CONSTRUCTION AND THAT FOLLOWING CONSTRUCTION, THE EXISTING IRRIGATION SYSTEM OPERATES AS GOOD, OR BETTER THAN EXISTED PRIOR TO THIS PROJECT.
- CONTRACTOR SHALL REPLACE, AT NO ADDITIONAL COST TO THE OWNER, PLANT MATERIALS DAMAGED DURING EXECUTION OF THIS PROJECT OR DAMAGED DUE TO THE CONTRACTORS FAILURE TO MAINTAIN OPERATION OF THE EXISTING SYSTEM DURING THE COARSE OF CONSTRUCTION.
- LANDSCAPE ARCHITECT IS NOT RESPONSIBLE FOR DISCREPANCIES BETWEEN DESIGN DRAWINGS AND ACTUAL SITE CHARACTERISTICS. CONTRACTOR SHALL FIELD VERIFY ALL INFORMATION PROVIDED ON DRAWINGS. CONTRACTOR SHALL STOP CONSTRUCTION AND CONTACT THE OWNER IMMEDIATELY FOR FURTHER DIRECTION IF DISCREPANCIES OCCUR.
- UPON COMPLETION, AND PRIOR TO FINAL PAYMENT, THE IRRIGATION CONTRACTOR SHALL PROVIDE A NEAT AND LEGIBLE AS-CONSTRUCTED IRRIGATION PLAN, AN OPERATION AND MAINTENANCE MANUAL, AND UP TO (8) HOURS OF ORIENTATION AND/OR TRAINING FOR THE OWNERS MAINTENANCE AND OPERATIONS STAFF.
- THE ENTIRE SYSTEM SHALL BE GUARANTEED FOR A PERIOD OF ONE YEAR FROM THE DATE OF IT'S ACCEPTANCE. REPAIR OR REPLACEMENT OF ANY DEFECTS OCCURRING WITHIN THAT YEAR SHALL BE COMPED PROMPTLY BY THE IRRIGATION CONTRACTOR AT NO ADDITIONAL COST TO THE OWNER.
- CONTRACTOR SHALL PROVIDE, AT NO ADDITIONAL COST TO THE OWNER, SPRING START UP AND WINTERIZATION DURING THE GUARANTEE PERIOD.

GENERAL LANDSCAPE NOTES

- VERIFICATION OF TOTAL LANDSCAPE MATERIAL QUANTITIES AS SHOWN ON THIS LANDSCAPE PLAN AND IN THE PLAN SCHEDULE SHALL BE THE RESPONSIBILITY OF THE LANDSCAPE CONTRACTOR. IF QUANTITIES LISTED DO NOT CORRELATE WITH WHAT IS SHOWN ON THE PLAN, THE QUANTITIES SHOWN ON THE PLAN SHALL GOVERN. THIS INCLUDES, BUT IS NOT LIMITED TO TREE, SHRUB, ROCK, TOPSOIL, MULCH, SEED OR SOD, EDGING, AND DRIP LINE QUANTITIES.
- IMMEDIATELY AFTER AWARD OF CONTRACT, NOTIFY THE LANDSCAPE ARCHITECT OF AVAILABILITY OF SPECIFIED PLANT MATERIAL FROM COMMERCIAL NURSERIES. IF A SPECIFIED PLANT IS NOT AVAILABLE, THE LANDSCAPE ARCHITECT WILL PROVIDE ALTERNATE PLANT MATERIAL SELECTIONS. SUCH CHANGES SHALL NOT ALTER THE ORIGINAL BID PRICE UNLESS A CREDIT IS DUE TO THE OWNER.
- CONTRACTOR SHALL LOCATE AND IDENTIFY EXISTING UNDERGROUND AND OVERHEAD UTILITIES WITHIN CONTRACT WORK AREAS PRIOR TO CONSTRUCTION. CONTACT DIG LINE, INC. @ 1.800.342.1885. PROVIDE ADEQUATE MEANS OF PROTECTION OF UTILITIES AND SERVICES DESIGNATED TO REMAIN. REPAIR UTILITIES DAMAGED DURING SITE WORK OPERATIONS AT CONTRACTOR'S EXPENSE.
- PROVIDE REQUIRED SOIL EROSION CONTROL MEASURES THROUGHOUT THE DURATION OF THE CONTRACT PERIOD. SHOULD THERE BE EXISTING SOIL EROSION CONDITIONS THAT REQUIRE MITIGATION, NOTIFY THE RESPONSIBLE PERSON IMMEDIATELY. FAILURE TO NOTIFY THE RESPONSIBLE PERSON IMPLIES ACCEPTANCE OF THE SITE IN ITS EXISTING CONDITION.
- LANDSCAPE CONTRACTOR SHALL BE RESPONSIBLE FOR PREPARING ALL PLANTED AREAS. ALL DELETERIOUS MATERIAL SUCH AS ROCK, TRASH, CONSTRUCTION DEBRIS, AGGREGATE BASE MATERIAL, ASPHALT, ETC., SHALL BE REMOVED PRIOR TO ANY FILL OPERATIONS. FINISH GRADES TO BE SMOOTH AND EVEN. GRADIENTS TO REMOVE LOW AND HIGH POINTS AND TO PROVIDE POSITIVE DRAINAGE.
- FILL ALL PLANTING AREAS WITH CLEAN EARTHEN FILL, AS PER SPECIFICATIONS. SOIL SHALL BE FREE OF HEAVY, STIFF CLAY AND ANY DELETERIOUS MATERIAL OVER ONE INCH IN SIZE. REUSE EXISTING SURFACE TOPSOIL IF AVAILABLE.
- TOPSOIL SHALL BE A LOOSE, FRIABLE, SANDY LOAM, CLEAN AND FREE OF TOXIC MATERIALS, NOXIOUS WEEDS, WEED SEEDS, ROCKS, GRASS, OR OTHER FOREIGN MATERIALS AND A PH OF 5.5 TO 7.0. IF ON-SITE TOPSOIL DOES NOT MEET THESE MINIMUM STANDARDS, CONTRACTORS ARE RESPONSIBLE TO EITHER: PROVIDE APPROVED IMPORTED TOPSOIL OR, AMEND THE ON-SITE TOPSOIL.
- TOPSOIL DEPTHS SHALL BE AS FOLLOWS (WHERE APPLICABLE): LAWN AREAS-6" MIN.; PLANTER BEDS - 12" MIN.; CURB ISLANDS - 18" MIN.ALL PLANTING BEDS SHALL BE TREATED WITH A PRE-EMERGENT HERBICIDE.
- FINISH GRADES FOR LANDSCAPE AREAS TO BE SMOOTH AND EVEN GRADIENTS WITH POSITIVE DRAINAGE IN ACCORDANCE WITH SITE GRADING PLAN. SLOPES FOR TURF AREAS SHALL NOT EXCEED 3:1.
- PRE-EMERGENT HERBICIDE SHALL BE APPLIED PER MANUFACTURER'S RECOMMENDATIONS AND SHALL OCCUR AFTER TOPSOIL PLACEMENT AND PRIOR TO INSTALLATION OF PLANT MATERIALS AND MULCH.
- ALL PLANT MATERIAL SHALL CONFORM TO THE AMERICAN NURSERYMAN STANDARDS FOR TYPE AND SIZE SHOWN. PLANTS WILL BE REJECTED IF NOT IN HEALTHY GROWING CONDITION.
- ALL WRAPPING MATERIAL SHALL BE CUT AND REMOVED FROM AROUND THE UPPER PORTION OF THE ROOT BALL. METAL BASKET WIRES AND BURLAP SHALL BE PULLED BACK AND TUCKED UNDER THE EDGES OF THE SAUCER RINGS ON ALL TREES AND LARGE SHRUBS. ALL SYNTHETIC BURLAP SHALL BE REMOVED FROM ROOT BALLS PRIOR TO BACKFILLING.
- ALL PLANT MATERIAL SHALL BE GUARANTEED FOR A PERIOD OF ONE YEAR BEGINNING AT THE DATE OF ACCEPTANCE BY OWNER. REPLACE ALL PLANT MATERIAL FOUND DEAD OR NOT IN HEALTHY CONDITION IMMEDIATELY WITH COMPARABLE SIZE AND SPECIES AT NO COST TO THE OWNER.
- FERTILIZE ALL TREES AND SHRUBS WITH AGRIFORM PLANTING TABLETS. QUANTITY PER MANUFACTURER'S RECOMMENDATIONS.
- CONTRACTOR'S MAINTENANCE SHALL INCLUDE:
 - PRUNING, CULTIVATING, WEEDING, WATERING, AND APPLICATION OF APPROPRIATE INSECTICIDES AND FUNGICIDES NECESSARY TO MAINTAIN PLANTS FREE OF INSECTS AND DISEASE UNTIL FINAL ACCEPTANCE BY OWNER.
 - RE-SET SETTLED PLANTS TO A PROPER GRADE AND POSITION.
 - RESTORE PLANTING SAUCER AND ADJACENT MATERIAL AND REMOVE AND REPLACE DEAD MATERIAL.
 - TIGHTEN AND REPAIR GUY WIRES AND STAKES AS REQUIRED ONLY IF ORIGINALLY NEEDED.
 - CORRECT DEFECTIVE WORK AS SOON AS POSSIBLE AFTER DEFICIENCIES BECOMES APPARENT AND WEATHER AND SEASON PERMIT.

TREE PROTECTION NOTES

- THE CONTRACTOR SHALL TAKE EXTREME CARE TO PROTECT THE CRITICAL ROOT ZONE OF ALL TREES AT ALL TIMES THROUGHOUT PROJECT.
- PRIOR TO COMMENCING WORK, TEMPORARY FENCING SHALL BE INSTALLED IMMEDIATELY AROUND EACH TREE IMPACTED BY DEMOLITION OR CONSTRUCTION. FENCING SHALL BE MAINTAINED THROUGHOUT THE COURSE OF THE ENTIRE DEMOLITION AND CONSTRUCTION PROCESS.
- BULK MATERIAL, EQUIPMENT, VEHICLES, AND CONSTRUCTION DEBRIS AND WASTE SHALL NOT BE STOCKPILED WITHIN HE CRITICAL ROOT ZONE.
- COMPACTION BY EQUIPMENT TRAFFIC IS PROHIBITED WITHIN THE CRITICAL ROOT ZONE.
- MAINTAIN WATERING WITHIN THE CRITICAL ROOT ZONE. APPLY A MIN. 1.5" OF WATER OVER THE CRITICAL ROOT ZONE PER WEEK. THIS IS A MIN. RECOMMENDATION. CONTRACTOR IS RESPONSIBLE TO DETERMINE IF MORE WATER IS NECESSARY DURING CONSTRUCTION.
- ANY DAMAGE TO EXISTING TREES DURING CONSTRUCTION SHALL BE THE CONTRACTORS RESPONSIBILITY. THE CONTRACTOR SHALL PERFORM REMEDIAL WORK TO DAMAGED TREES AT THE CONTRACTOR'S EXPENSE.

PLANT SCHEDULE SEE L2.0 FOR FULL PLANT SCHEDULE				
DECIDUOUS TREES	CODE	QTY	BOTANICAL / COMMON NAME	SIZE
	AP2	28	ACER TRUNCATUM 'PACIFIC SUNSET' TM PACIFIC SUNSET MAPLE	2" CAL B&B
	CC	14	CERCIS CANADENSIS EASTERN REDBUD	2" CAL B&B
	GS2	28	GLEDITSIA TRIACANTHOS 'SKYLINE' SKYLINE HONEY LOCUST	2" CAL B&B
	PVC	24	PRUNUS VIRGINIANA 'CANADA RED' CANADA RED CHOKECHERRY	2" CAL B&B
	PC2	33	PYRUS CALLERYANA 'CAPITAL' CAPITAL CALLERY PEAR	2" CAL B&B
	TG	32	TILIA CORDATA 'GREENSPIRE' GREENSPIRE LITTLELEAF LINDEN	2" CAL B&B
EVERGREEN TREES	CODE	QTY	BOTANICAL / COMMON NAME	SIZE
	CK	28	CEDRUS DEODARA 'KARL FUCHS' FUCHS DEODAR CEDAR	6'-8" B&B
	PP2	20	PICEA GLAUCA PENDULA WEeping WHITE SPRUCE	6'-8" B&B
	PH	26	PICEA PUNGENS 'HOOPSII' HOOPSII BLUE SPRUCE	6'-8" B&B
	PV	7	PINUS FLEXILIS 'VANDERWOLF'S PYRAMID' VANDERWOLF'S PYRAMID PINE	6'-8" B&B
EXISTING TREES	CODE	QTY	BOTANICAL / COMMON NAME	SIZE
	SP	27	EXISTING TREES TO REMAIN PRESERVE AND PROTECT. SEE KEY NOTE 9.	EXISTING
SOD/SEED	CODE	QTY	BOTANICAL / COMMON NAME	CONT
	TR	163,372 SF	TURF SOD RHIZOMATOUS RHIZOMATOUS TALL FESCUE	SOD

STREET TREE CALCULATIONS (1TREE/35 LF, 1 SHRUB/7 LF)

STREET NAME	LF	SHRUBS		TREES	
		REQUIRED	PROVIDED	REQUIRED	PROVIDED
S. KCID RD.	269	38	77	8	8
FOREST DR.	2011	287	304	58	58
TURQUOISE AVE.	167	24	24	5	6
CLAW AVE.	690	99	103	20	20
SURPRISE WAY	874	125	134	25	25
RANGER ST.	294	42	43	8	8
				118	119

TOTAL STREET TREES

PATHWAY CALCULATIONS

8-10' MACRO PATHWAY (1 TREE/40 LF, 15 SHRUB/100 LF)

BLOCK #	LOT #	LF	SHRUBS		TREES	
			REQUIRED	PROVIDED	REQUIRED	PROVIDED
1	10	156	23	23	4	4
1	29	766	115	119	19	19

4-5' MICRO PATHWAY (1 TREE/40 LF, 15 SHRUB/100 LF)

BLOCK #	LOT #	LF	SHRUBS		TREES	
			REQUIRED	PROVIDED	REQUIRED	PROVIDED
1	1	776	116	240	19	19
1	29	193	29	34	4	4
2	1	717	108	406	7	9

TOTAL PATHWAY TREES REQUIRED/PROVIDED

53 55

NOTE: THIS PLAN COMPLIES WITH CITY CODE CHAPTER 10-7 (CALDWELL LANDSCAPING ORDINANCE).

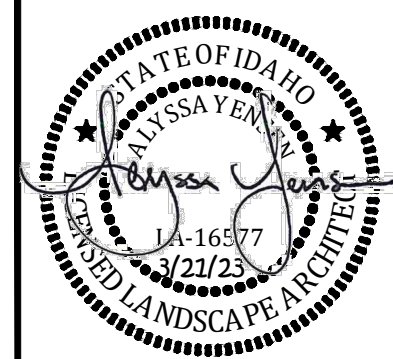

REVISIONS		DATE	ITEM	PID AND CITY COMMENTS	OWNER FENCING COMMENTS
NO.	1	12/01/22			
	2	3/21/23			

COUGAR CROSSING SUBDIVISION
CALDWELL, ID

LANDSCAPE COVER

km
ENGINEERING
5725 NORTH DISCOVERY WAY
BOISE, IDAHO 83713
PHONE (208) 639-6939
kmengllp.com

DESIGN BY: WHB
DRAWN BY: WHB
CHECKED BY: AY
DATE: 08/09/22
PROJECT: 22-118
SHEET NO.



1. INSTALL 3' DIAMETER SHOVEL CUT TREE RING, WITH BARE EARTH SURFACE AT ALL TREES WITHIN TURF AREAS.
2. CLEAR VISION TRIANGLE. NO TREES SHALL BE PLANTED WITHIN A CLEAR VISION TRIANGLE. THE MAXIMUM HEIGHT OF ANY VEGETATIVE GROUND COVER AT MATURITY WITHIN THE CLEAR VISION TRIANGLE SHALL BE 3' FROM THE ADJACENT STREET GRADE.
3. ALL PLANTED BEDS TO RECEIVE A MIN. 3" DEPTH ORGANIC PERMABARK MULCH WITH PERMEABLE FABRIC WEED BARRIER. SUBMIT SAMPLE TO OWNER FOR APPROVAL PRIOR TO ORDERING AND INSTALLING. THE USE OF MULCH OR ROCK AS THE ONLY GROUND COVER IN REQUIRED PLANTING AREAS IS PROHIBITED. IMPERMEABLE PLASTIC WEED BARRIERS ARE PROHIBITED.
4. INSTALL FLAT-BLADE SHOVEL EDGING AT INTERFACE OF SOD AND PLANTER BED. SEE L4.0-2.
5. 6' HEIGHT TAN VINYL PRIVACY FENCE. SEE L5.0 FOR FENCE EXHIBIT AND DETAIL.
6. DOG PARK WITH ENYPET ARTIFICIAL TURF AND CONTAINMENT CURB OR APPROVED EQUAL. SEE L4.0-5.
7. TOT LOT. OWNER SELECTED, CONTRACTOR INSTALLED. CONTRACTOR SHALL PROVIDE (2) TOT LOT EQUIPMENT OPTIONS TO OWNER FOR SELECTION. INSTALL PER MANUFACTURERS RECOMMENDATIONS.
8. BLACK DUMOR BENCH SEATING. SEE L4.0-4.
9. EXISTING TREES TO REMAIN. PRESERVE AND PROTECT. SEE TREE PROTECTION NOTES AND PLANT SCHEDULE.
10. COVERED PAVILION WITH BBQ AREA. SEE ARCHITECTURAL PLANS.
11. MAIL BOX CLUSTER. SEE ARCHITECTURAL PLANS.
12. PROPOSED MACRO PATHWAY. SEE CIVIL PLANS.
13. PROPOSED MICRO PATHWAY. SEE CIVIL PLANS.
14. SURFACE MOUNTED BLACK DUMORE BIKE RACK OR APPROVED EQUAL. SEE L4.0-8.
15. 24" VERTICAL CONCRETE CURB. SEE L4.0-7.
16. LANDSCAPE ACCENT BOULDERS. SIZE VARIES. EQUALLY DISTRIBUTE SIZES. $\frac{1}{3}$ (4'X5') $\frac{1}{3}$ (3'X4') $\frac{1}{3}$ (2'X3'). BOULDERS SHALL BE OBTAINED FROM OWNER DESIGNATED SOURCE. SEE L4.0-3.
17. DOG WASTE STATION WITH ROLL BAG SYSTEM. BLACK IN COLOR. WWW.DOGWASTEDEPOT.COM. DEPOT-006-B OR APPROVED EQUAL. PRODUCT TO INCLUDE POST, SIGN, WASTE BAD DISPENSER, ROUND WASTE CAN WITH LID, 400 ROLL BAGS, 25 CAN LINERS, INSTALLATION INSTRUCTIONS AND HARDWARE. SEE L4.0-6.
18. 4' HEIGHT CLEAR VIEW BLACK METAL FENCE. SEE L5.0 FOR FENCE EXHIBIT AND DETAIL.
19. SAND WINDOW. SLOPE TO DRAIN. CONTRACTOR TO FIELD VERIFY. SEE L4.0-9.

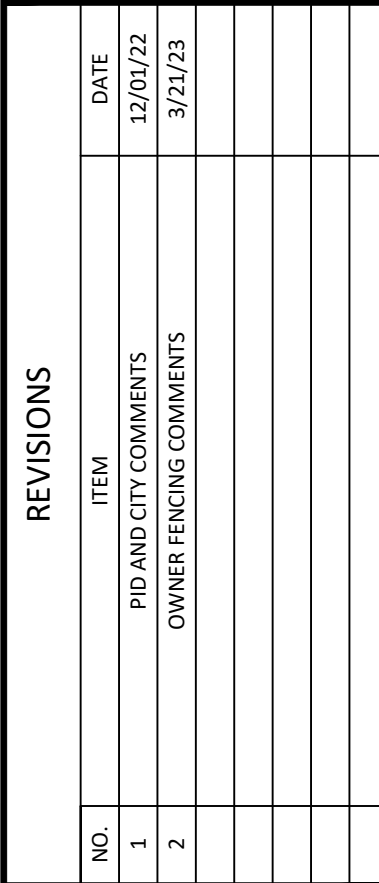

COUGAR CROSSING SUBDIVISION
CALDWELL, ID
LANDSCAPE PLAN

LANDSCAPE PLAN

P:\22-118\CA\LANDSCAPE\CONSTRUCTION\LANDSCAPE PLAN.DWG, 3/21/2023, WHITNEY BRETZ, 3/21/2023, CANON PLOTTER (BW) PLOT 22034, L [PDF]



PLANT SCHEDULE

DECIDUOUS TREES			CODE	QTY	BOTANICAL / COMMON NAME
			AP2	28	ACER TRUNCATUM 'PACIFIC SUNSET' TM PACIFIC SUNSET MAPLE
			CC	14	CERCIS CANADENSIS EASTERN REDBUD
			GS2	28	GLEDITSIA TRIACANTHOS 'SKYLINE' SKYLINE HONEY LOCUST
			PVC	24	PRUNUS VIRGINIANA 'CANADA RED' CANADA RED CHOKECHERRY
			PC2	33	PYRUS CALLERYANA 'CAPITAL' CAPITAL CALLERY PEAR
			TG	32	TILIA CORDATA 'GREENSPIRE' GREENSPIRE LITTLELEAF LINDEN
EVERGREEN TREES			CODE	QTY	BOTANICAL / COMMON NAME
			CK	28	CEDRUS DEODARA 'KARL FUCHS' FUCHS DEODAR CEDAR
			PP2	20	PICEA GLAUCA PENDULA WEeping WHITE SPRUCE
			PH	26	PICEA PUNGENS 'HOOPSII' HOOPSII BLUE SPRUCE
			PV	7	PINUS FLEXILIS 'VANDERWOLF'S PYRAMID' VANDERWOLF'S PYRAMID PINE
EXISTING TREES			CODE	QTY	BOTANICAL / COMMON NAME
			SP	27	EXISTING TREES TO REMAIN PRESERVE AND PROTECT. SEE KEY NOTE 9.
SHRUBS			CODE	QTY	BOTANICAL / COMMON NAME
			BO	15	BERBERIS THUNBERGII 'ORANGE ROCKET' ORANGE ROCKET JAPANESE BARBERRY
			BF	64	BUXUS MICROPHYLLA 'FAULKNER' FAULKNER BOXWOOD
			CB2	97	CARYOPTERIS X CLANDONENSIS 'BLUE MIST' BLUE MIST SHRUB
			HL2	76	HYDRANGEA PANICULATA 'LITTLE LIME' LITTLE LIME HYDRANGEA
			PG	72	PICEA PUNGENS 'GLOBOSA' DWARF GLOBE BLUE SPRUCE
			RR2	42	RHAMNUS FRANGULA 'FINE LINE' FINE LINE BUCHTHORN
			RD	54	ROSA X 'DOUBLE KNOCKOUT' (RED) RED DOUBLE KNOCKOUT ROSE
			RN2	118	ROSA X 'NOARE' FLOWER CARPET RED GROUNDCOVER ROSE
			SS	60	SPIRAEA NIPPONICA 'SNOWMOUND' SNOWMOUND SPIREA
GRASSES			CODE	QTY	BOTANICAL / COMMON NAME
			BB	87	BOUTELOUA GRACILIS 'BLONDE AMBITION' BLONDE AMBITIONS BLUE GRAMMA GRASS
			HB2	66	FESTUCA IDAHOENSIS IDAHO FESCUE
			MM	123	MISCANTHUS SINENSIS 'MORNING LIGHT' EULALIA GRASS
			PH3	152	PENNISETUM ALOPECUROIDES 'HAMELN' HAMELN DWARF FOUNTAIN GRASS
			PL	85	PENNISETUM ALOPECUROIDES 'LITTLE BUNNY' LITTLE BUNNY DWARF FOUNTAIN GRASS

PERENNIALS			CODE	QTY	BOTANICAL / COMMON NAME
			EW	85	ECHINACEA X 'BALSOMANITA' TM SOMBREIRO SANGRITA CONEFLOWER
			GI	72	GERANIUM X 'JOHNSON'S BLUE' JOHNSON'S BLUE GERANIUM
			HS	98	HEMEROCALLIS X 'STELLA DE ORO' STELLA DE ORO DAYLILY
			LT	115	LAVANDULA ANGUSTIFOLIA 'THUMBELINA LEIGH' THUMBELINA LEIGH ENGLISH LAVENDER
			NJ	105	NEPETA X FAASSENII 'JUNIOR WALKER' JUNIOR WALKER CATMINT
			RG2	106	RUBRIBECKIA FULGIDA 'GOLDSTRUM' GOLDSTRUM BLACK-EYED SUSAN
			SM	85	SALVIA NEMOROSA 'MAY NIGHT' MAY NIGHT SAGE
SOD/SEED			CODE	QTY	BOTANICAL / COMMON NAME
			TR	163,372 SF	TURF SOD RHIZOMATOUS RHIZOMATOUS TALL FESCUE

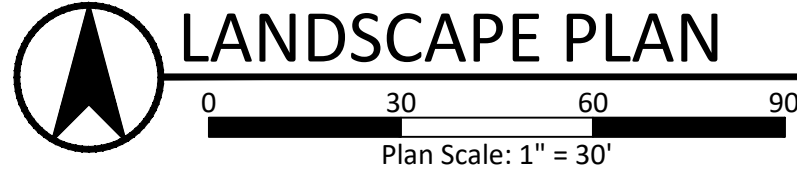

KEY NOTES (TYPICAL) (#)

1. INSTALL 3' DIAMETER SHOVEL CUT TREE RING, WITH BARE EARTH SURFACE AT ALL TREES WITHIN TURF AREAS.
2. CLEAR VISION TRIANGLE. NO TREES SHALL BE PLANTED WITHIN A CLEAR VISION TRIANGLE. THE MAXIMUM HEIGHT OF ANY VEGETATIVE GROUND COVER AT MATURITY WITHIN THE CLEAR VISION TRIANGLE SHALL BE 3' FROM THE ADJACENT STREET GRADE.
3. ALL PLANTED BEDS TO RECEIVE A MIN. 3" DEPTH ORGANIC PERMABARK MULCH WITH PERMEABLE FABRIC WEED BARRIER. SUBMIT SAMPLE TO OWNER FOR APPROVAL PRIOR TO ORDERING AND INSTALLING. THE USE OF MULCH OR ROCK AS THE ONLY GROUND COVER IN REQUIRED PLANTING AREAS IS PROHIBITED. IMPERMEABLE PLASTIC WEED BARRIERS ARE PROHIBITED.
4. INSTALL FLAT-BLADE SHOVEL EDGING AT INTERFACE OF SOD AND PLANTER BED. SEE L4.0-2.
5. 6' HEIGHT TAN VINYL PRIVACY FENCE. SEE L5.0 FOR FENCE EXHIBIT AND DETAIL.
6. DOG PARK WITH ENYPET ARTIFICIAL TURF AND CONTAINMENT CURB OR APPROVED EQUAL. SEE L4.0-5.
7. TOT LOT. OWNER SELECTED, CONTRACTOR INSTALLED. CONTRACTOR SHALL PROVIDE (2) TOT LOT EQUIPMENT OPTIONS TO OWNER FOR SELECTION. INSTALL PER MANUFACTURERS RECOMMENDATIONS.
8. BLACK DUMOR BENCH SEATING. SEE L4.0-4.
9. EXISTING TREES TO REMAIN. PRESERVE AND PROTECT. SEE TREE PROTECTION NOTES AND PLANT SCHEDULE.
10. COVERED PAVILION WITH BBQ AREA. SEE ARCHITECTURAL PLANS.
11. MAIL BOX CLUSTER. SEE ARCHITECTURAL PLANS.
12. PROPOSED MACRO PATHWAY. SEE CIVIL PLANS.
13. PROPOSED MICRO PATHWAY. SEE CIVIL PLANS.
14. SURFACE MOUNTED BLACK DUMORE BIKE RACK OR APPROVED EQUAL. SEE L4.0-8.
15. 24" VERTICAL CONCRETE CURB. SEE L4.0-7.
16. LANDSCAPE ACCENT BOULDERS. SIZE VARIES. EQUALLY DISTRIBUTE SIZES. $\frac{1}{3}$ (4'X5') $\frac{1}{3}$ (3'X4') $\frac{1}{3}$ (2'X3'). BOULDERS SHALL BE OBTAINED FROM OWNER DESIGNATED SOURCE. SEE L4.0-3.
17. DOG WASTE STATION WITH ROLL BAG SYSTEM. BLACK IN COLOR. WWW.DOGWASTEDEPOT.COM. DEPOT-006-B OR APPROVED EQUAL. PRODUCT TO INCLUDE POST, SIGN, WASTE BAD DISPENSER, ROUND WASTE CAN WITH LID, 400 ROLL BAGS, 25 CAN LINERS, INSTALLATION INSTRUCTIONS AND HARDWARE. SEE L4.0-6.
18. 4' HEIGHT CLEAR VIEW BLACK METAL FENCE. SEE L5.0 FOR FENCE EXHIBIT AND DETAIL.
19. SAND WINDOW. SLOPE TO DRAIN. CONTRACTOR TO FIELD VERIFY. SEE L4.0-9.

MATCH LINE - SEE SHEET L3.0



REVISIONS		DATE	ITEM	DATE
NO.	NO.	DATE	ITEM	DATE
1	1	12/01/22	PID AND CITY COMMENTS	3/21/23
2	2		OWNER FENCING COMMENTS	

COUGAR CROSSING SUBDIVISION
CALDWELL, ID
LANDSCAPE PLAN



DESIGN BY:	WHB
DRAWN BY:	WHB
CHECKED BY:	AY
DATE:	08/09/22
PROJECT:	22-118
SHEET NO.	L3.0

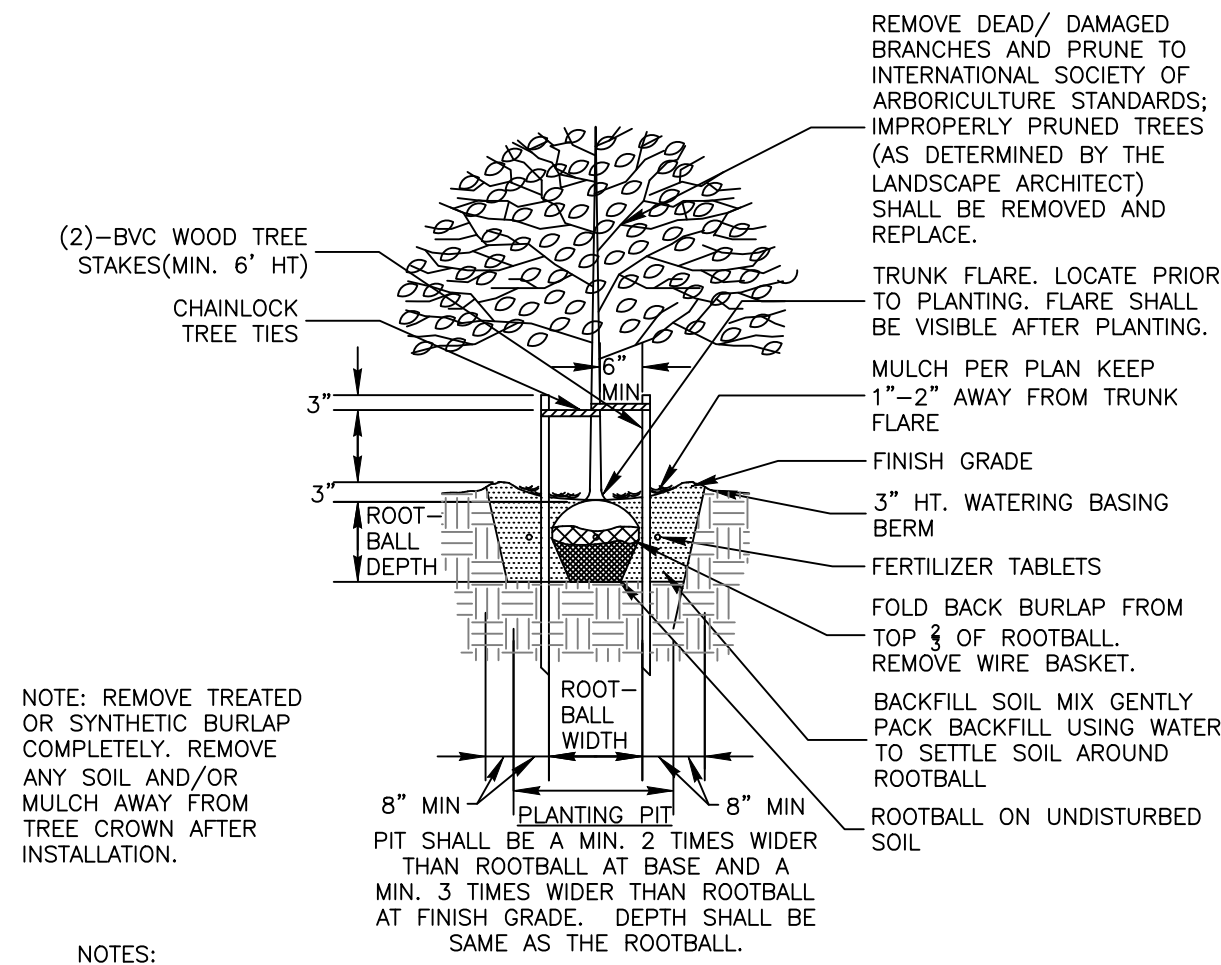

1 DECIDUOUS TREE PLANTING AND STAKING DETAIL

NTS

2 SHOVEL CUT EDGE

NTS

3 BOULDER INSTALLATION DETAIL

NTS

4 BENCH DETAIL

NTS

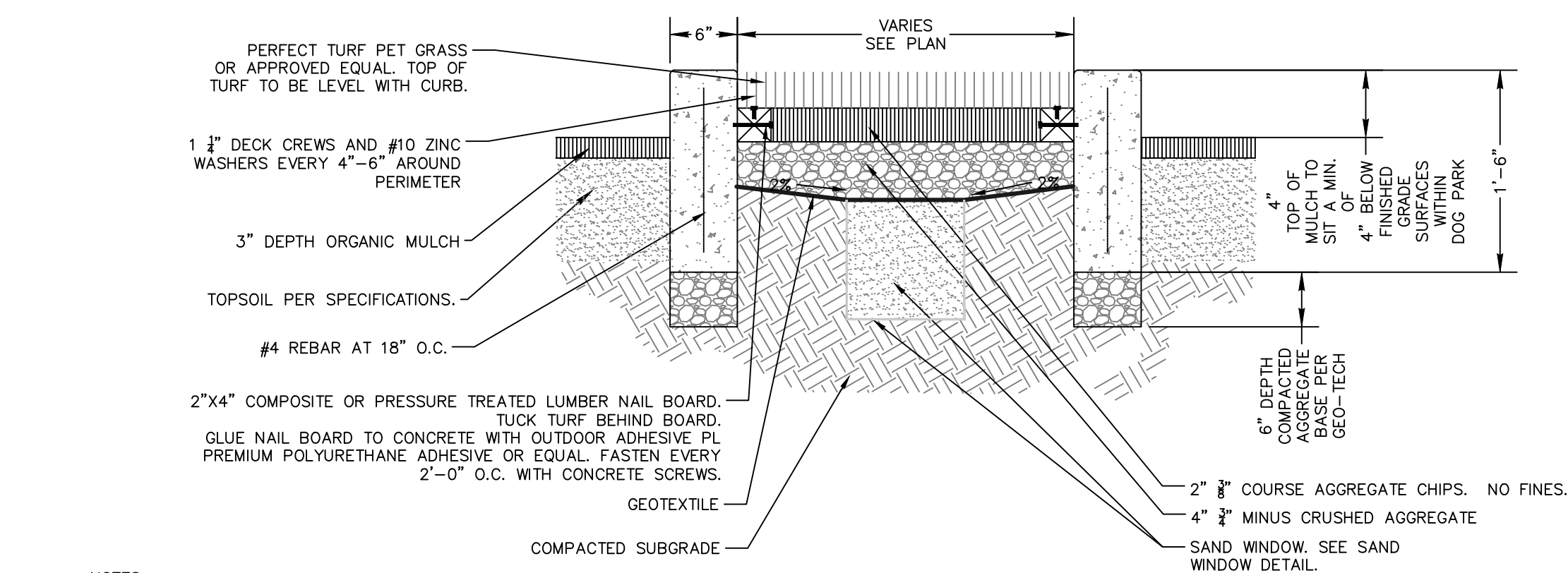

5 DOG PARK ARTIFICIAL TURF, SAND WINDOW, AND CONCRETE CONTAINMENT CURB

NTS

6 DOG WASTE STATION

NTS

7 PLAYGROUND CURB AND SAFETY SURFACING

NTS

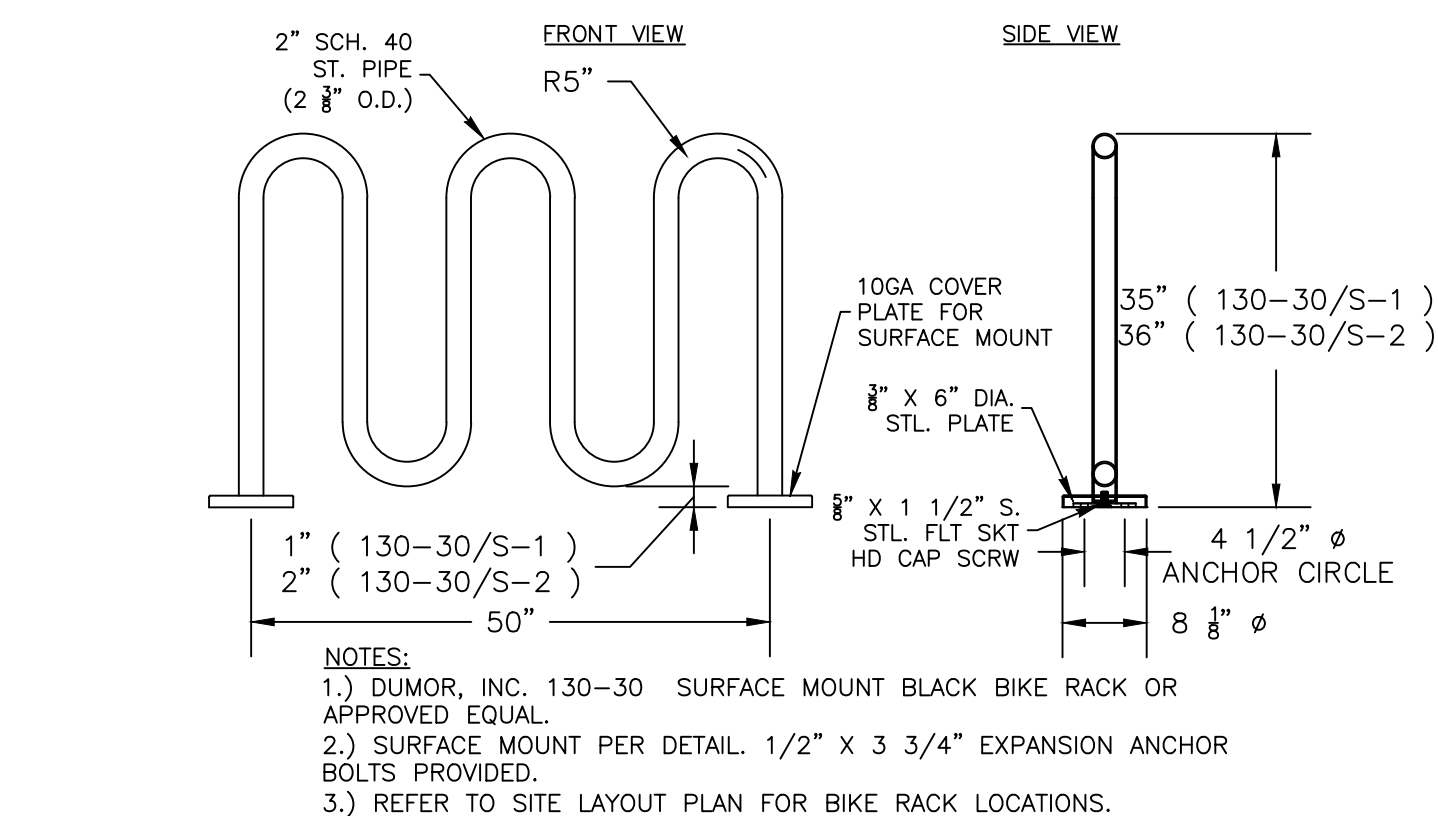

8 BIKE RACK DETAIL

NTS

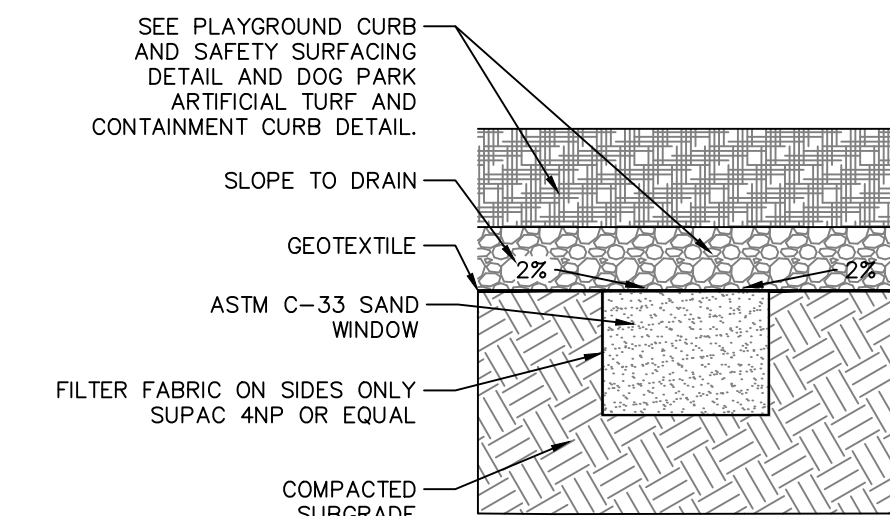

9 SAND WINDOW

NTS

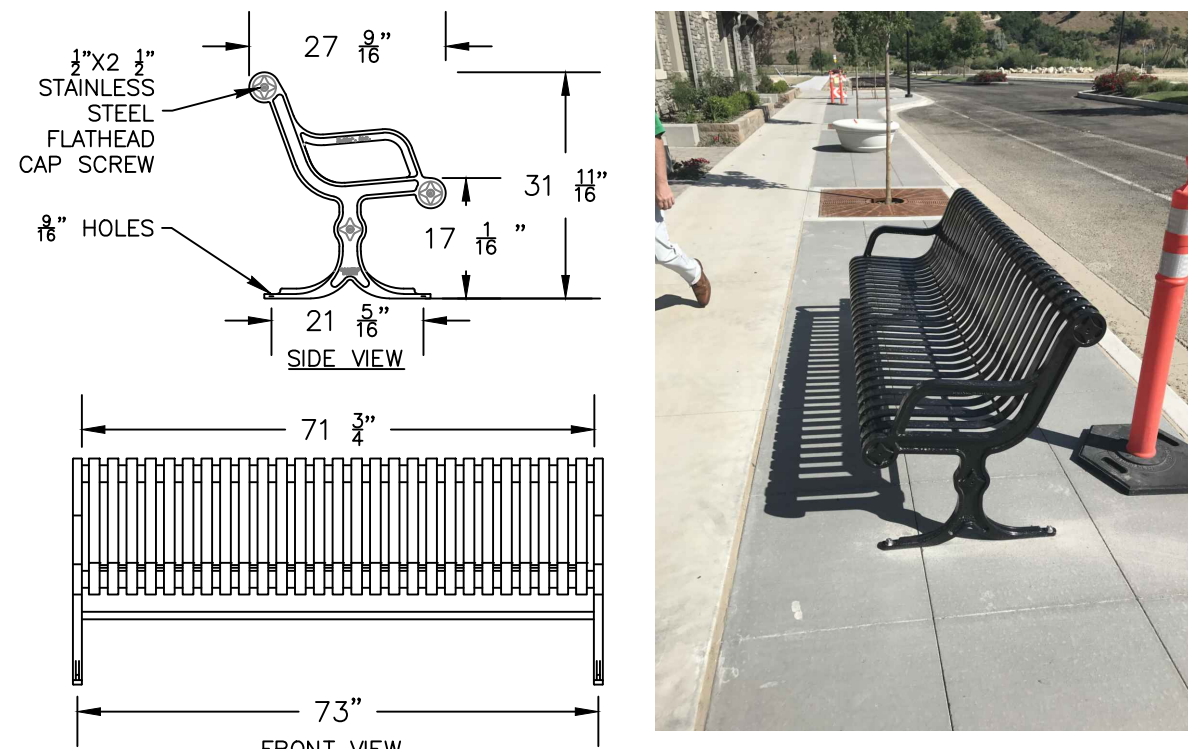

- NOTES:
1. 140-60 BENCH BY DuMor WITH NO CENTER ARM REST
 2. FINISH TO BE POWERCOATED BLACK.
 3. REFER TO LAYOUT PLAN FOR BENCH LOCATION.
 4. INSTALL PER MANUFACTORY RECOMMENDATION.

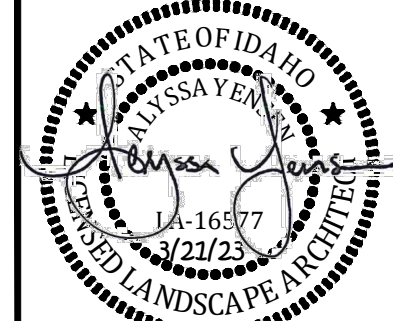
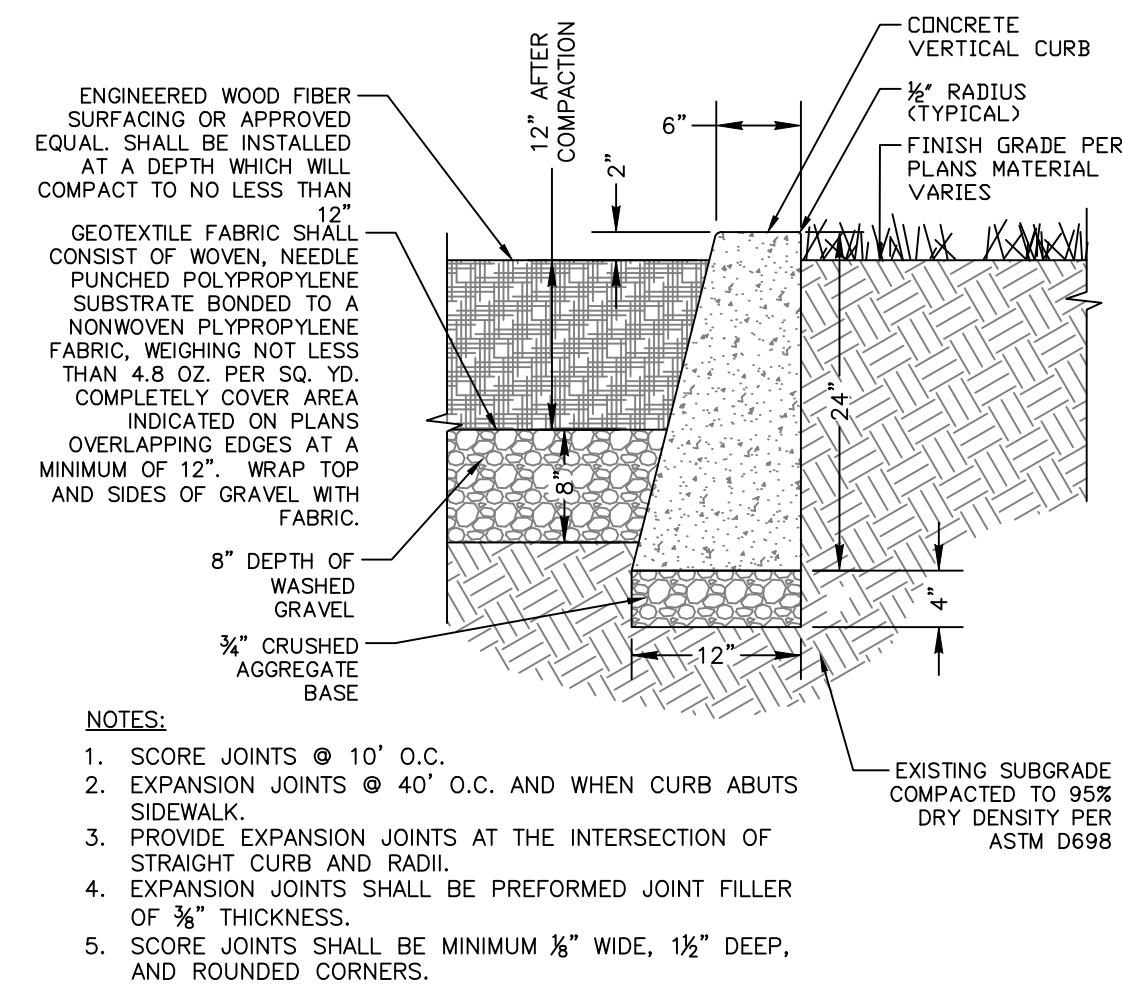
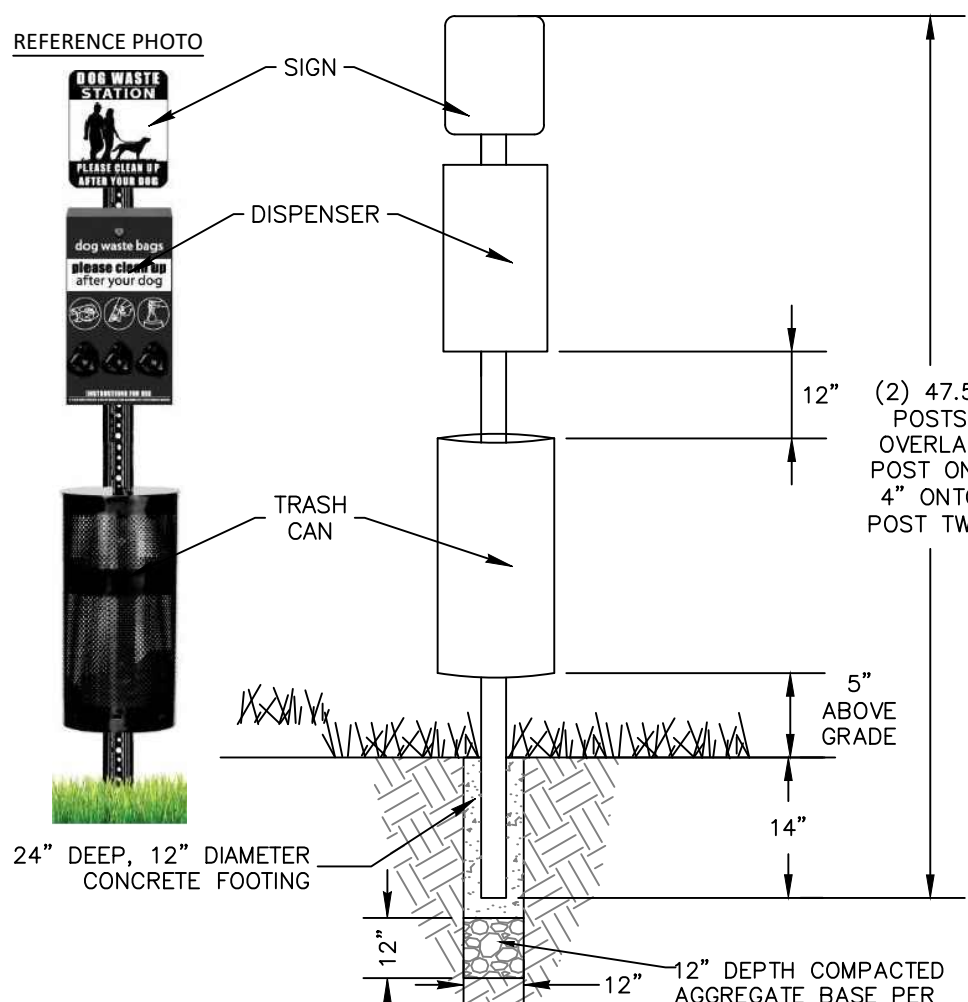

REVISIONS		DATE	ITEM
NO.	ITEM	PID AND CITY COMMENTS	OWNER FENCING COMMENTS
1		12/01/22	
2		3/21/23	

COUGAR CROSSING SUBDIVISION CALDWELL, ID

LANDSCAPE DETAILS

km
ENGINEERING
5725 NORTH DISCOVERY WAY
BOISE, IDAHO 83713
PHONE (208) 639-6939
kmengllp.com

DESIGN BY: WHB
DRAWN BY: WHB
CHECKED BY: AY
DATE: 08/09/22
PROJECT: 22-118

SHEET NO.

L4.0



REVISIONS		DATE
NO.	ITEM	
1	PID AND CITY COMMENTS	12/01/22
2	OWNER FENCING COMMENTS	3/21/23

COUGAR CROSSING SUBDIVISION
CALDWELL, ID
FENCE EXHIBIT

km
ENGINEERING
5725 NORTH DISCOVERY WAY
BOISE, IDAHO 83713
PHONE (208) 639-6939
kmengllp.com

DESIGN BY:	WHB
DRAWN BY:	WHB
CHECKED BY:	AY
DATE:	08/09/22
PROJECT:	22-118

SHEET NO. L5.0

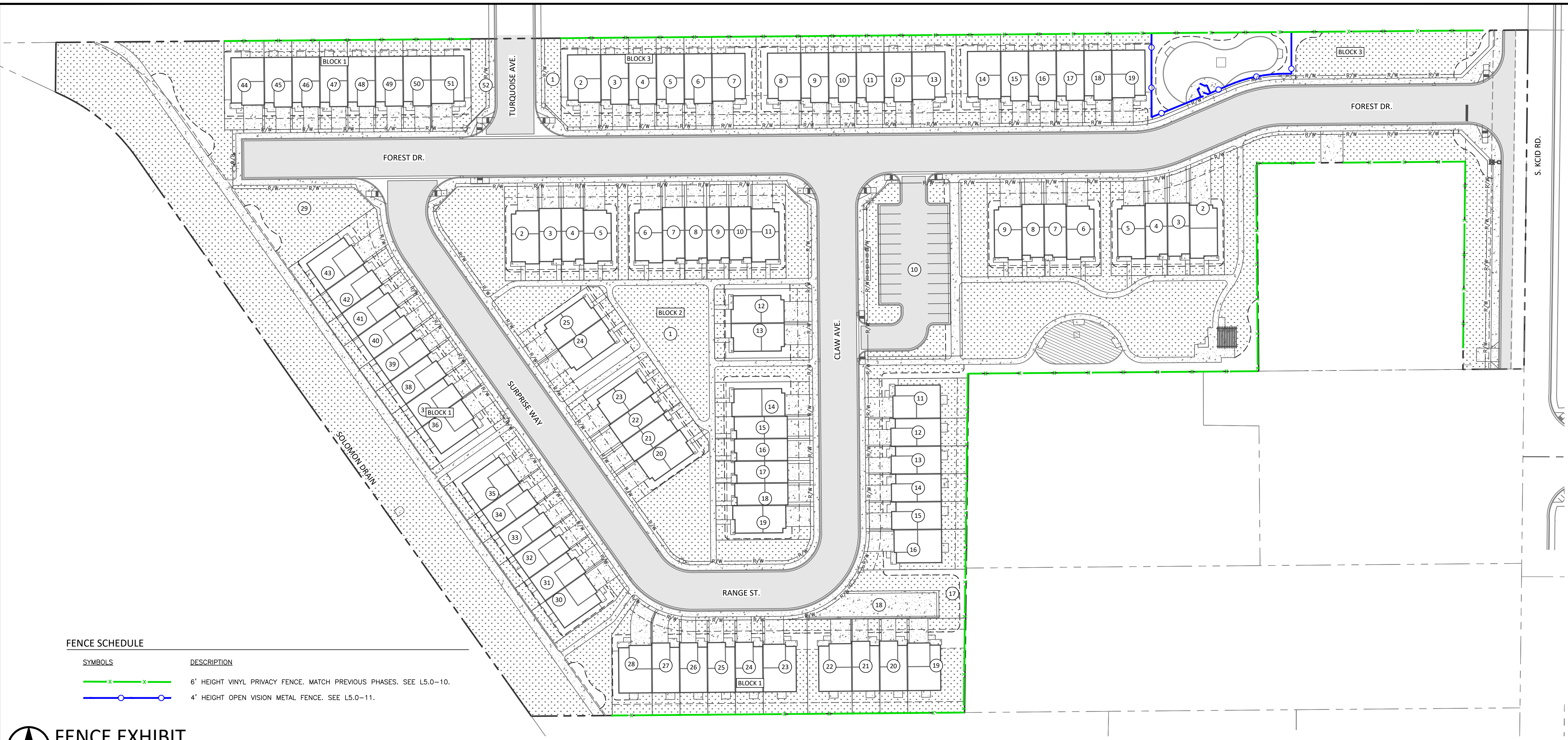

FENCE SCHEDULE	
SYMBOLS	DESCRIPTION
	6' HEIGHT VINYL PRIVACY FENCE. MATCH PREVIOUS PHASES. SEE L5.0-10.
	4' HEIGHT OPEN VISION METAL FENCE. SEE L5.0-11.

FENCE EXHIBIT
0 50 100 150
Plan Scale: 1" = 50'

POST FOOTING SECTION

POST FOOTING PLAN VIEW

REFERENCE PHOTO

NOTES:

1. REFER TO PLAN FOR FENCE LOCATION.

2. ALL SOLID VINYL FENCE PANELING TO BE TAN.

10 6' VINYL FENCE AND POST

NTS

TOP VIEW FENCE PANEL POST FOOTING

TOP VIEW GATE POST FOOTING

NOTES:

1. ALL FENCING COMPONENTS TO BE BLACK.

2. ALL WELDS TO BE ALUMINUM.

11 4' METAL FENCE

NTS

P:\22-118\CAO\LANDSCAPE\CONSTRUCTION PLANS\22-118.CAD LANDSCAPE PLAN.DWG, WHITNEY BRETZ, 3/21/2023, CANON PLOT755 (BW) PLOT 22034, L [PDF]

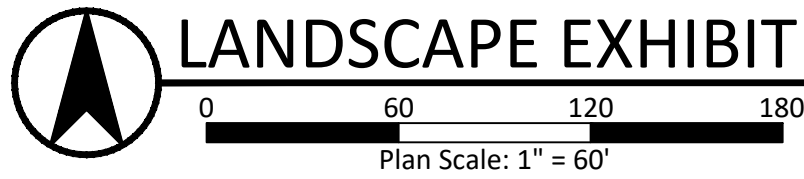
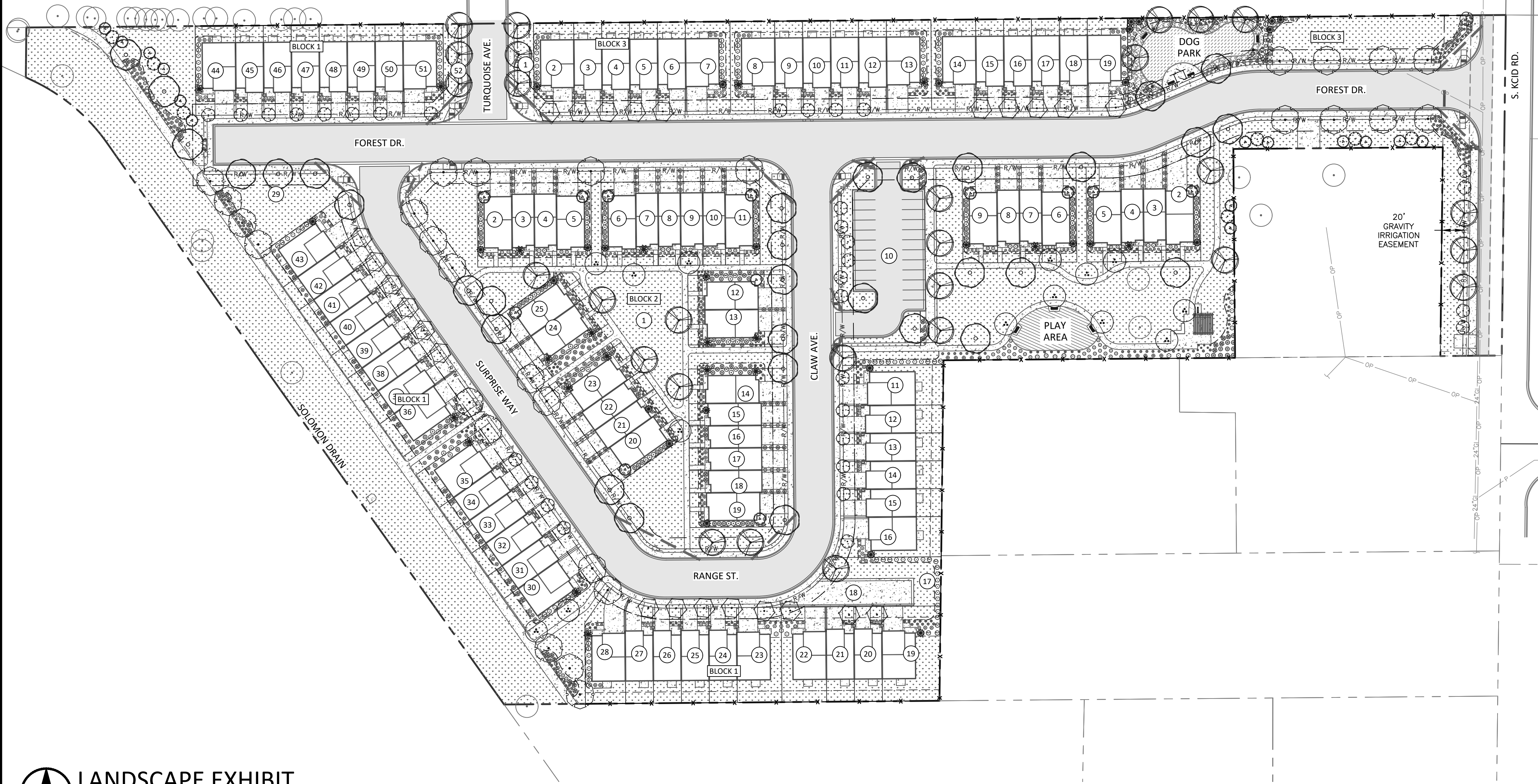

STREET TREE CALCULATIONS (1TREE/35 LF, 1 SHRUB/7 LF)						
STREET NAME	LF	SHRUBS		TREES		
		REQUIRED	PROVIDED	REQUIRED	PROVIDED	
S. KCID RD.	269	38	77	8	8	
FOREST DR.	2011	287	304	58	58	
TURQUOISE AVE.	167	24	24	5	6	
CLAW AVE.	690	99	103	20	20	
SURPRISE WAY	874	125	134	25	25	
RANGER ST.	294	42	43	8	8	
TOTAL STREET TREES				118	119	
PATHWAY CALCULATIONS						
8-10' MACRO PATHWAY (1 TREE/40 LF, 15 SHRUB/100 LF)						
BLOCK #	LOT #	LF	SHRUBS		TREES	
			REQUIRED	PROVIDED	REQUIRED	PROVIDED
1	10	156	23	23	4	4
1	29	766	115	122	19	19
4-5' MICRO PATHWAY (1 TREE/40 LF, 15 SHRUB/100 LF)						
BLOCK #	LOT #	LF	SHRUBS		TREES	
			REQUIRED	PROVIDED	REQUIRED	PROVIDED
1	1	776	116	240	19	19
1	29	193	29	34	4	4
2	1	717	108	406	7	9
TOTAL PATHWAY TREES REQUIRED/PROVIDED					53	55
NOTE: THIS PLAN COMPLIES WITH CITY CODE CHAPTER 10-7 (CALDWELL LANDSCAPING ORDINANCE).						

PLANT SCHEDULE					
DECIDUOUS TREES	CODE	QTY	BOTANICAL / COMMON NAME	SIZE	
	AP2	28	ACER TRUNCATUM 'PACIFIC SUNSET' TM PACIFIC SUNSET MAPLE	2" CAL. B&B	
	CC	14	CERCIS CANADENSIS EASTERN REDBUD	2" CAL. B&B	
	GS2	28	GLEDITSIA TRIACANTHOS 'SKYLINE' SKYLINE HONEY LOCUST	2" CAL. B&B	
	PVC	24	PRUNUS VIRGINIANA 'CANADA RED' CANADA RED CHOKECHERRY	2" CAL. B&B	
	PC2	33	PYRUS CALLERYANA 'CAPITAL' CAPITAL CALLERY PEAR	2" CAL. B&B	
	TG	32	TILIA CORDATA 'GREENSPIRE' GREENSPIRE LITTLELEAF LINDEN	2" CAL. B&B	
EVERGREEN TREES	CODE	QTY	BOTANICAL / COMMON NAME	SIZE	
	CK	28	CEDRUS DEODARA 'KARL FUCHS' FUCHS DEODAR CEDAR	6'-8" B&B	
	PP2	20	PICEA GLAUCA PENDULA WEeping WHITE SPRUCE	6'-8" B&B	
	PH	26	PICEA PUNGENS 'HOOPSII' HOOPSII BLUE SPRUCE	6'-8" B&B	
	PV	7	PINUS FLEXILIS 'VANDERWOLF'S PYRAMID' VANDERWOLF'S PYRAMID PINE	6'-8" B&B	
EXISTING TREES	CODE	QTY	BOTANICAL / COMMON NAME	SIZE	
	SP	27	EXISTING TREES TO REMAIN PRESERVE AND PROTECT. SEE KEY NOTE 9.	EXISTING	
SHRUBS	CODE	QTY	BOTANICAL / COMMON NAME	SIZE	
	BO	15	BERBERIS THUNBERGII 'ORANGE ROCKET' ORANGE ROCKET JAPANESE BARBERRY	2 GAL.	
	BF	64	BUXUS MICROPHYLLA 'FAULKNER' FAULKNER BOXWOOD	2 GAL.	
	CB2	97	CARYOPTERIS X CLANDONENSIS 'BLUE MIST' BLUE MIST SHRUB	2 GAL.	
	HL2	76	HYDRANGEA PANICULATA 'LITTLE LIME' LITTLE LIME HYDRANGEA	2 GAL.	
	PG	72	PICEA PUNGENS 'GLOBOSA' DWARF GLOBE BLUE SPRUCE	2 GAL.	
	RR2	42	RHAMNUS FRANGULA 'FINE LINE' FINE LINE BUCHTHORN	6'-8" B&B	
	RD	54	ROSA X 'DOUBLE KNOCKOUT' (RED) RED DOUBLE KNOCKOUT ROSE	2 GAL.	
	RN2	118	ROSA X 'NOARE' FLOWER CARPET RED GROUNDCOVER ROSE	2 GAL.	
	SS	60	SPHRAEA NIPPONICA 'SNOWMOUND' SNOWMOUND SPIREA	2 GAL.	
GRASSES	CODE	QTY	BOTANICAL / COMMON NAME	SIZE	
	BB	87	BOUTELLOUA GRACILIS 'BLONDE AMBITION' BLONDE AMBITIONS BLUE GRAMMA GRASS	1 GAL.	
	HB2	66	FESTUCA IDAHOENSIS IDAHO FESCUE	1 GAL.	
	MM	123	MISCANTHUS SINENSIS 'MORNING LIGHT' EULALIA GRASS	1 GAL.	
	PH3	152	PENNISETUM ALOPECUROIDES 'HADELIN' HADELIN DWARF FOUNTAIN GRASS	1 GAL.	
	PL	85	PENNISETUM ALOPECUROIDES 'LITTLE BUNNY' LITTLE BUNNY DWARF FOUNTAIN GRASS	1 GAL.	
PERENNIALS	CODE	QTY	BOTANICAL / COMMON NAME	SIZE	
	EW	85	ECHINACEA X 'BALSOMANITA' TM SOMBREIRO SANGRITA CONEFLOWER	1 GAL.	
	GJ	72	GERANIUM X 'JOHNSON'S BLUE' JOHNSON'S BLUE GERANIUM	1 GAL.	
	HS	98	HEMEROCALLIS X 'STELLA DE ORO' STELLA DE ORO DAYLILY	1 GAL.	
	LT	115	LAVANDULA ANGUSTIFOLIA 'THUMBELINA LEIGH' THUMBELINA LEIGH ENGLISH LAVENDER	1 GAL.	
	NJ	105	NEPETA X FAASSENII 'JUNIOR WALKER' JUNIOR WALKER CATMINT	1 GAL.	
	RG2	106	RUDBECKIA FULGIDA 'GOLDSTRUM' GOLDSTRUM BLACK-EYED SUSAN	1 GAL.	
	SM	85	SALVIA NEMOROSA 'MAY NIGHT' MAY NIGHT SAGE	1 GAL.	
SOD/SEED	CODE	QTY	BOTANICAL / COMMON NAME	CONT	
	TR	163,372 SF	TURF SOD RHIZOMATOUS RHIZOMATOUS TALL FESCUE	SOD	

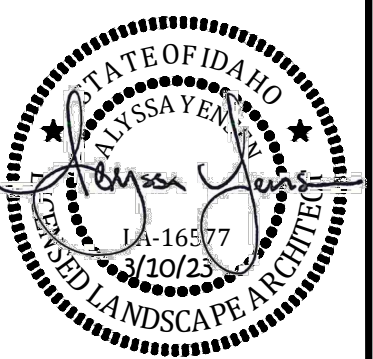

REVISIONS		DATE	ITEM	DATE	ITEM
NO.	1	12/01/22	FID AND CITY COMMENTS		

COUGAR CROSSING SUBDIVISION
CALDWELL, ID
LANDSCAPE EXHIBIT



DESIGN BY:	WHB
DRAWN BY:	WHB
CHECKED BY:	AY
DATE:	08/09/22
PROJECT:	22-118

SHEET NO.
L1.0